

Doc. credit number 63560/8520313/3
 insurance effected by Binosh Alborz Insurance Co.
 TLX No. 88903851 in Iran under insurance policy no. 85/100/38478

Item	Remarks for Issue	Date	Drawn	Checked	Appr.
A	FOR PREPARATION				
B	Issue total length 20.81 m	26.03.07	TS		

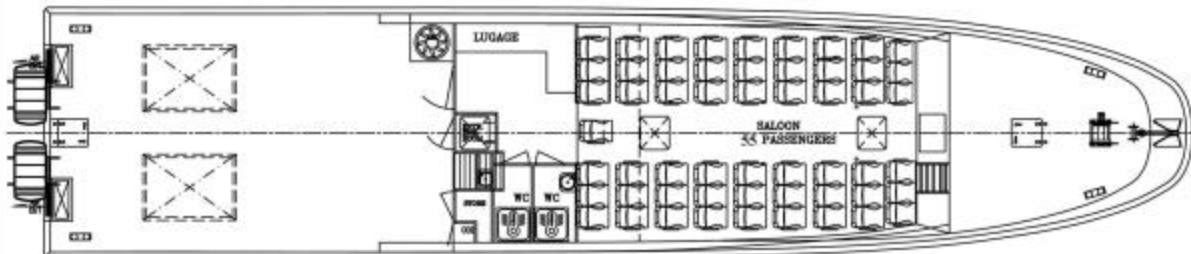
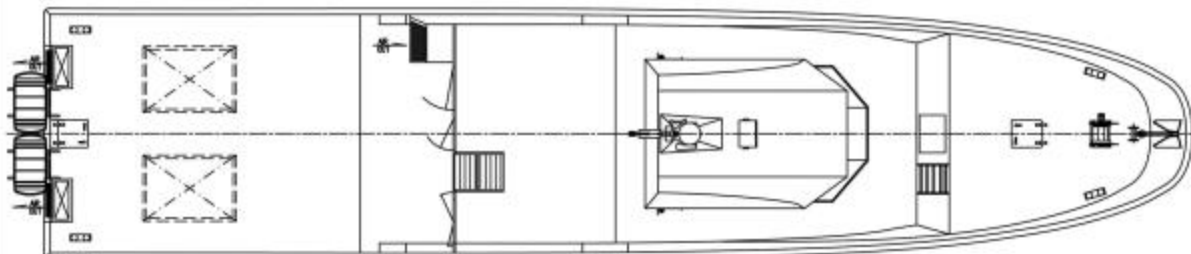
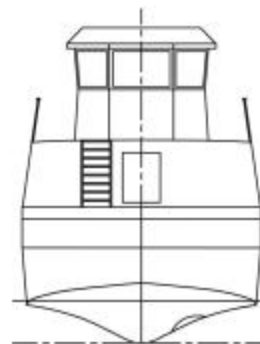
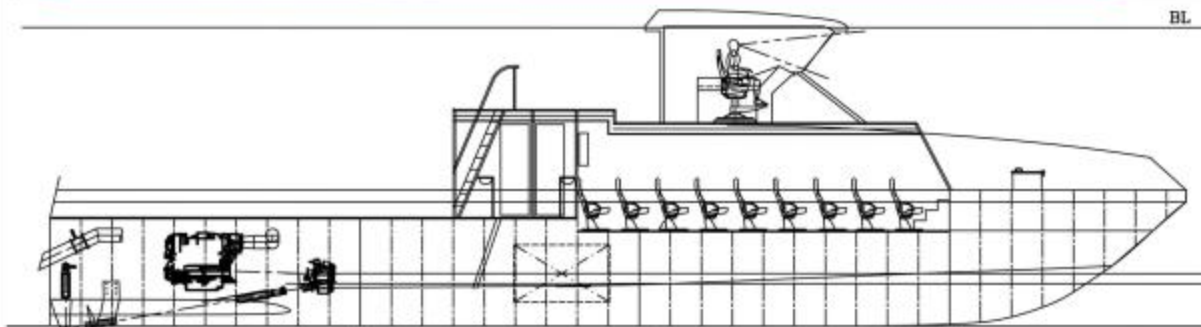
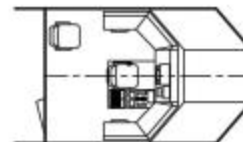

Sivilingenior

Ola Lillox-Olsen



*Knud Arneholdt
 Design Research Development*

MAIN DIMENSIONS :

- LENGHT OVER ALL : 23.81 M
- LENGHT IN WATERLINE : 21.20 M
- BEAM HULL : 5.00 M
- DRAFT : 1.35 M
- DEPTH MAIN DECK : 1.70 M
- NO. OF PASSENGERS : 55
- HOLD

This drawing/arrangement is the property of BatService Mandal A/S and must be returned upon request. The information and know-how herein are confidential and may not be copied, reproduced or revealed to others, in whole or in part, except with the prior written consent of BatService Mandal A/S. Any permitted reproduction must bear this legend.

CONFIDENTIAL
 This drawing/document is not remain the property of BatService Mandal A/S and must be returned upon request. The information and know-how herein are confidential and may not be copied, reproduced or revealed to others, in whole or in part, except with the prior written consent of BatService Mandal A/S. Any permitted reproduction must bear this legend.

BatService Mandal as	DATE: 16.11.06	SCALE: 1:50
	NO: 67-10-16730	PROJECT: OLO/MPH
GENERAL ARRANGEMENT		
DRAWING NO: 67-10-16730		REV: B