

***SEA LORD 30 M CREW / CARGO
TRANSPORTATION VESSEL***



 ***Batservice* Mandal as**

Tlf: + 47 38 27 13 00 Fax: + 47 38 26 45 80

E-mail: post@batservice.no

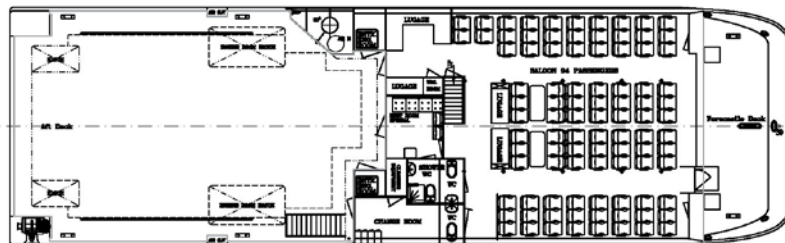
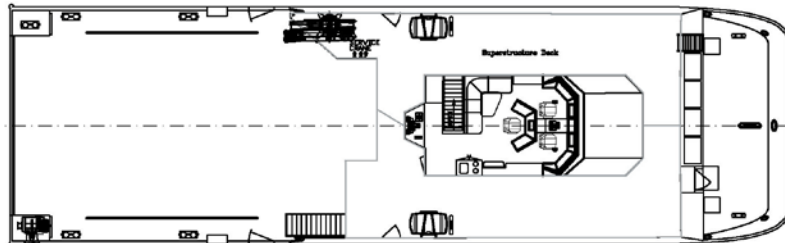
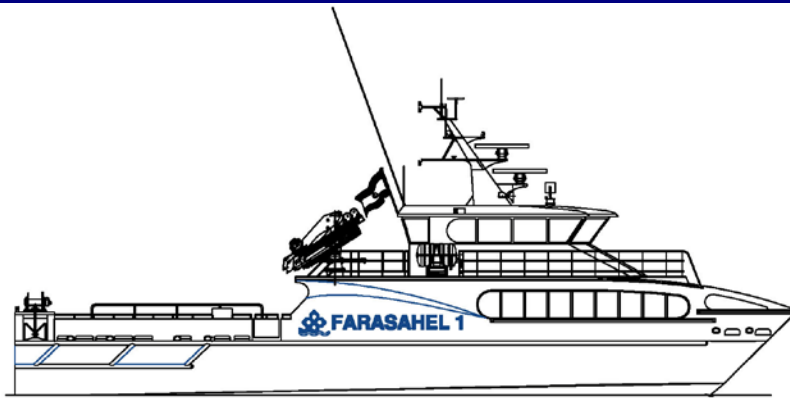

SHORT SPECIFICATION FOR SEA LORD 30 M CREW/CARGO VESSEL

Buyer:	Iran Investment, Iran	Diesel Cargo capacity:	20.000 l.
Designer:	Båtservice Mandal A/S	Diesel/Fuel capacity:	5000 l.
Route:	Persian Gulf	Fresh water capacity:	600 l.
Delivered:	August 2008	Engines:	2 x 12VMTU2000 M72
		Gear:	Servogear HD295HR-PTO
Building material:	Aluminum Alloy	Steering engines:	Scana Mar-EI ME-SG 23/xFU
Length overall:	29,65 m	El-system:	380V, 3PH, 50Hz-65kva x2
Beam:	9,00 m	Auxiliary engines:	2x John Deere 4045FM 57 kW
Draft:	1,80 m	Navigation:	Autopilot Gyrokompass Magnetic Compass NOR 250 2x Radar El. Map System
Speed:	28 knots		
Seats:	94		
Crew:	3		
Deck cargo:	Approx 15.000 kg		
Cargo Capacity:	20.000 liter	Communication:	GMDSS A1 + A2
Authorities:	DNV, 1A1, HSLC R3 Crew		