

***SEA LORD 30 M CREW / CARGO  
TRANSPORTATION VESSEL***

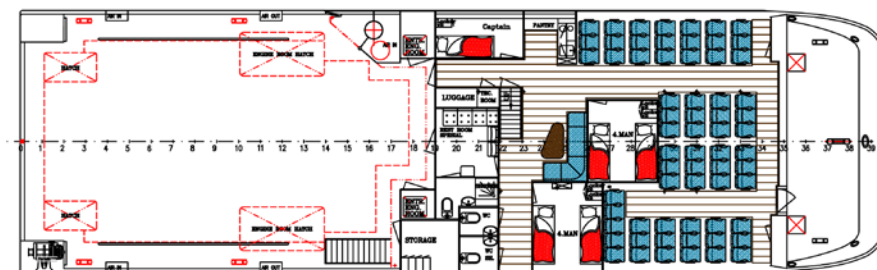

 ***Batservice* Mandal as**

Tlf: + 47 38 27 13 00 Fax: + 47 38 26 45 80  
E-mail: [post@batservice.no](mailto:post@batservice.no)

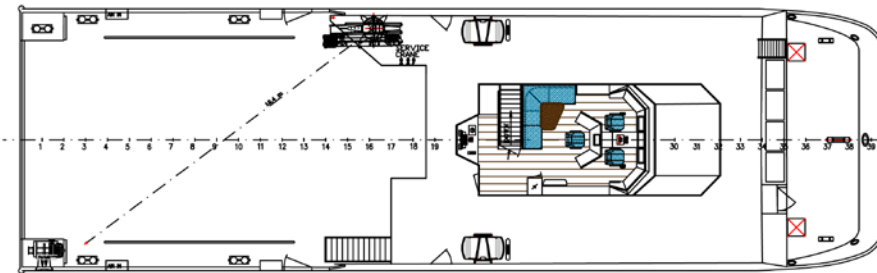
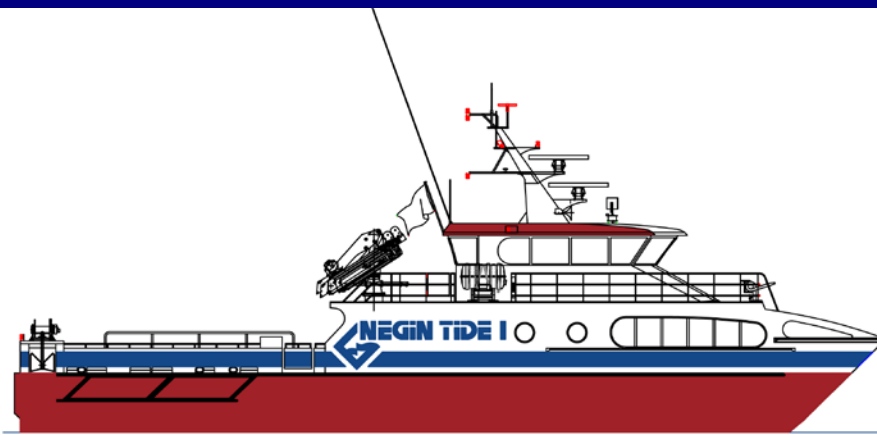

## SHORT SPECIFICATION FOR SEA LORD 30 M CREW/CARGO VESSEL

<b>Buyer:</b>	Tidewater, Iran	<b>Diesel Cargo capacity:</b>	20.000 liter
<b>Designer:</b>	Båtservice Mandal A/S	<b>Diesel/Fuel capacity:</b>	6000 liter.
<b>Route:</b>	Persian Gulf	<b>Fresh water capacity:</b>	1.000 liter
<b>Delivered:</b>	2010	<b>Engines:</b>	2 x 12VMTU2000 M72
		<b>Gear:</b>	ZF 3050
		<b>Propeller:</b>	Mitchigan
<b>Building material:</b>	Aluminum Alloy	<b>Steering engines:</b>	Scana Mar-El ME-SG 23/xFU
<b>Length overall:</b>	29,65 m	<b>El-system:</b>	380V, 3PH, 50Hz-65kva x2
<b>Beam:</b>	9,00 m	<b>Auxiliary engines:</b>	2x John Deere 4045FM 57 kW
<b>Draft:</b>	1,80 m	<b>Navigation:</b>	Autopilot Gyrokompass Magnetic Compass NOR 250 2x Radar El. Map System
<b>Speed:</b>	28 knots +	<b>Communication:</b>	GMDSS A1 + A2
<b>Seats:</b>	65		
<b>Crew:</b>	3		
<b>Deck cargo:</b>	Approx 45.000 kg		
<b>Fresh water cargo:</b>	10.000 liter		
<b>Authorities:</b>	DNV, 1A1, HSLC R3 Crew		